

Standard partlist for WT330 – SED(MED)

Pos	article-No.	description	number	category	remark
	WT330-SED	welding torch	1	WM25	3,0 mtr. Cable length
	WT330-MED	welding torch	1	WM25	4,5 mtr. Cable length
1*	U608N02	Nozzle	1	WP32	I.D. 16 mm
2*	U4167L00	Insulator	1	WP32	
3*	K980C32	Contact tip	1	WP32	
4*	U4170G03	Tip body	1	WP32	
5*	U4167G02	Orifice	1	WP32	
6*	U5783B00	Torch body	1	WP32	
6,1	3574-001	O-ring (S9)	1	WP35	
7	U5341G01	Cap	1	WP35	
8	U5035G03	Parallel pin	1	WP35	
9	U5035G00	Handle	1	WP35	Incl. screws
9,1	100-0308	Screw for handle			M4 x 20
9,2	100-0306	Screw for handle			M4 x 16
10	U5035E01	Trigger	1	WP35	
11	U157E04	Spring	1	WP35	
12	4254-137	Micro switch	1	WP35	Dustproof type
13	U5035K00	Cable support	1	WP35	Incl. screws
13,1	100-0306	Screw for cable support	4		M4 x 16
14*	U4170H02	Liner, 3.0 mtr	1	WP32	0.9 - 1.2 mm
	U4535G01	Liner, 4.5 mtr. 1		WP32	1.0 - 1.2 mm
15	U5350D00	Power cable, 3.0 mtr. 1 WP35 89,30			Incl. support spring
	U5351D00	Power cable, 4.5 mtr. 1 WP35			Incl. support spring
15,1	100-0310	Socket screw	1		M5 x 14
16	U5685N00	Adaptor nut	1	WP35	
17	U5779E00	Adaptor	1	WP35	Euro connection
17,1	3573-002	O - ring	1	WP35	
17,2	100-0297	Screw	1		M4 x 8
18	U5779E01	Liner nut 1		WP35	

*=consumables

OTC DAIHEN EUROPE GmbH

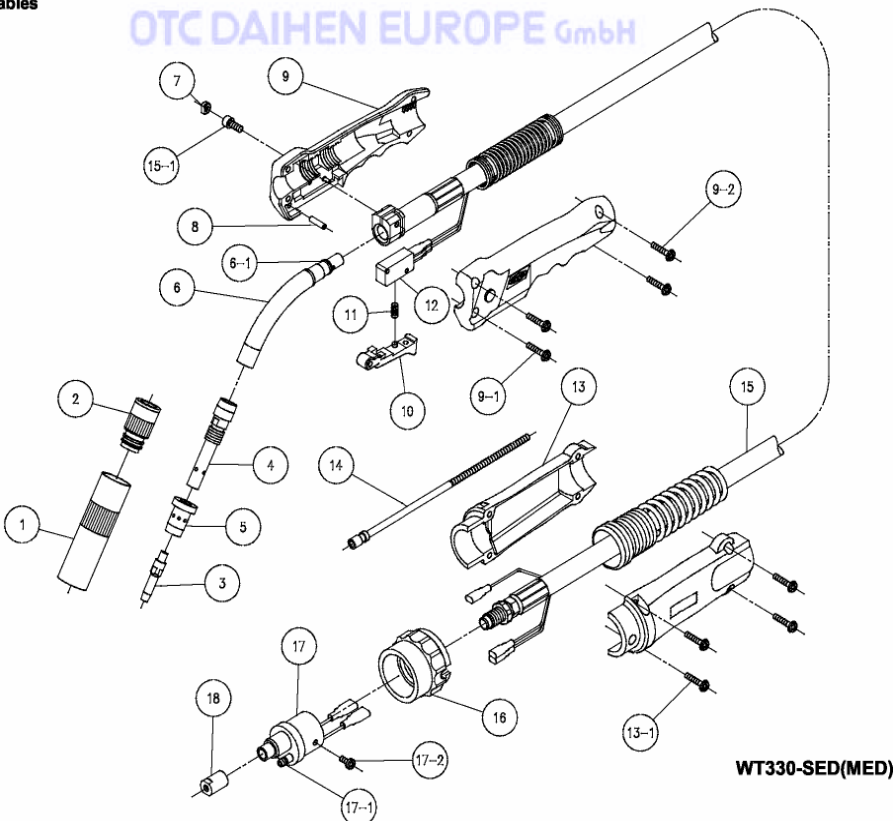

WT330-SED(MED)

*=consumables

WT330-SED(MED)